

# AMANDA SUBDIVISION

PART OF FRACTIONAL NORTH HALF OF SECTION 19, T.12N.-R.4E.  
SAGINAW TOWNSHIP, SAGINAW COUNTY, MICHIGAN

SPICER ENGINEERING COMPANY  
SAGINAW, MICHIGAN  
1971

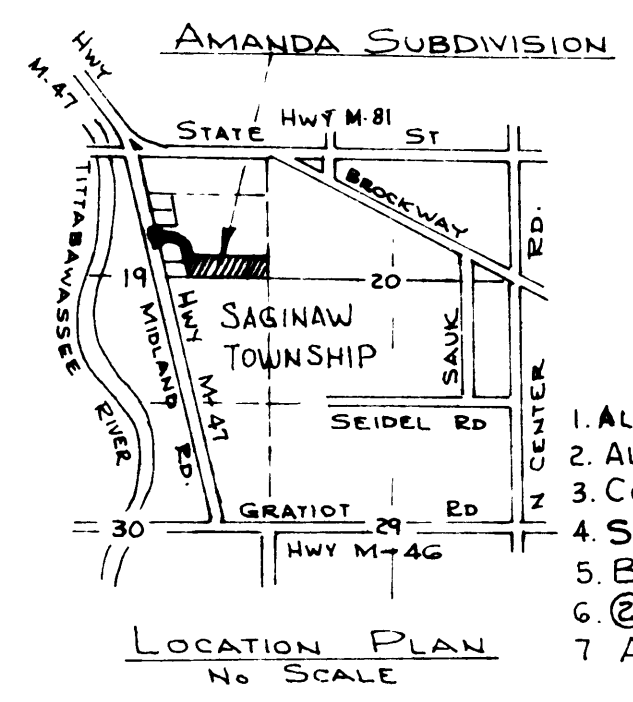
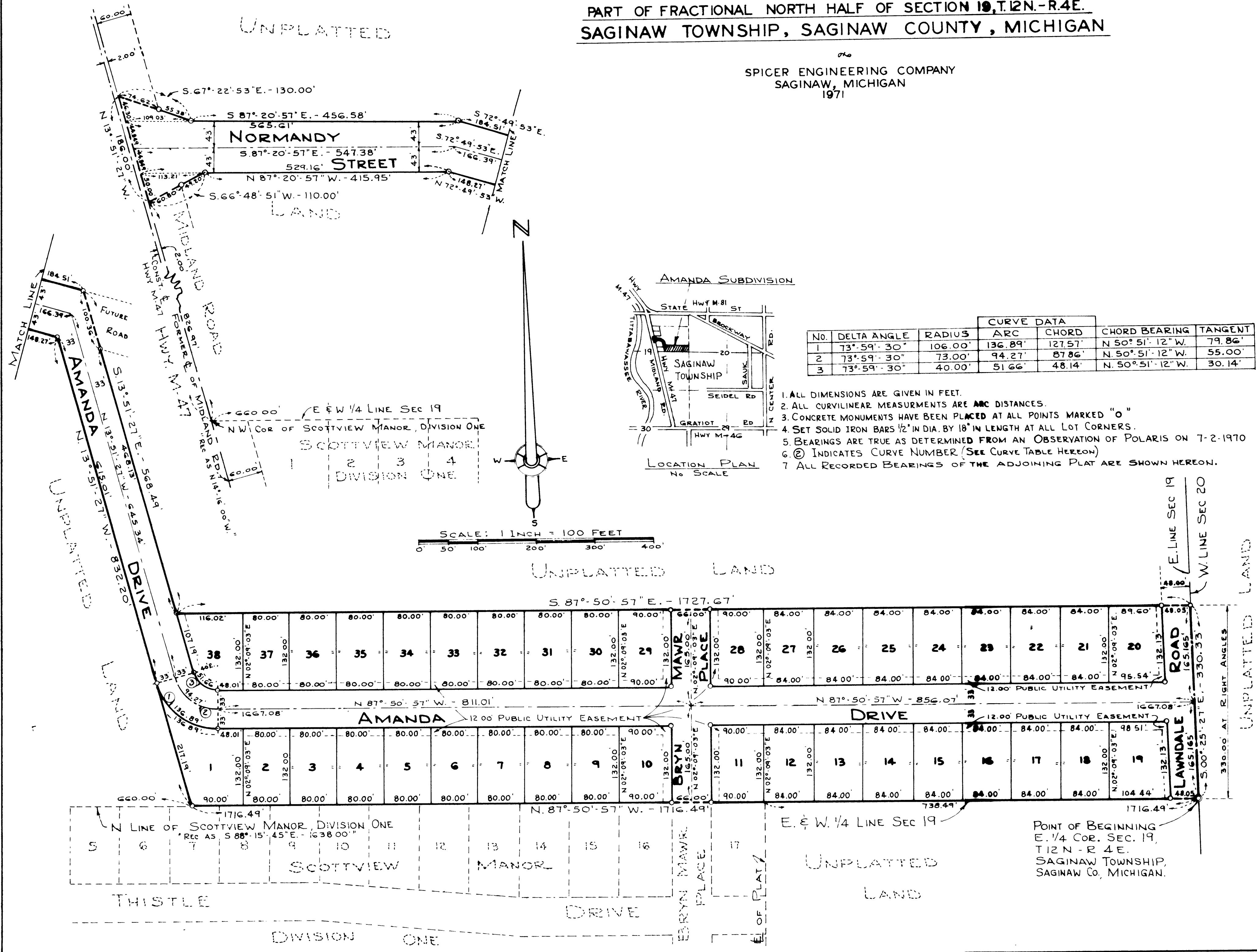

CURVE DATA						
NO.	DELTA ANGLE	RADIUS	ARC	CHORD	CHORD BEARING	TANGENT
1	73°-59'-30"	106.00'	136.89'	127.57'	N 50°-51'-12" W.	79.86'
2	73°-59'-30"	73.00'	94.27'	87.86'	N 50°-51'-12" W.	55.00'
3	73°-59'-30"	40.00'	51.66'	48.14'	N 50°-51'-12" W.	30.14'

1. ALL DIMENSIONS ARE GIVEN IN FEET.
2. ALL CURVILINEAR MEASUREMENTS ARE ARC DISTANCES.
3. CONCRETE MONUMENTS HAVE BEEN PLACED AT ALL POINTS MARKED "O"
4. SET SOLID IRON BARS 1/2" IN DIA. BY 18" IN LENGTH AT ALL LOT CORNERS.
5. BEARINGS ARE TRUE AS DETERMINED FROM AN OBSERVATION OF POLARIS ON 7-2-1970
6. © INDICATES CURVE NUMBER (SEE CURVE TABLE HEREON)
7. ALL RECORDED BEARINGS OF THE ADJOINING PLAT ARE SHOWN HEREON.

POINT OF BEGINNING  
E. 1/4 COR. SEC. 19,  
T.12N.-R.4E.  
SAGINAW TOWNSHIP,  
SAGINAW Co., MICHIGAN.