

MAYFLOWER ESTATES NUMBER TWO

PART OF THE NORTHWEST 1/4, SECTION 29, T.12N-R.4E.
SAGINAW TOWNSHIP, SAGINAW COUNTY, MICHIGAN

SPICER ENGINEERING COMPANY
SAGINAW, MICHIGAN
1972

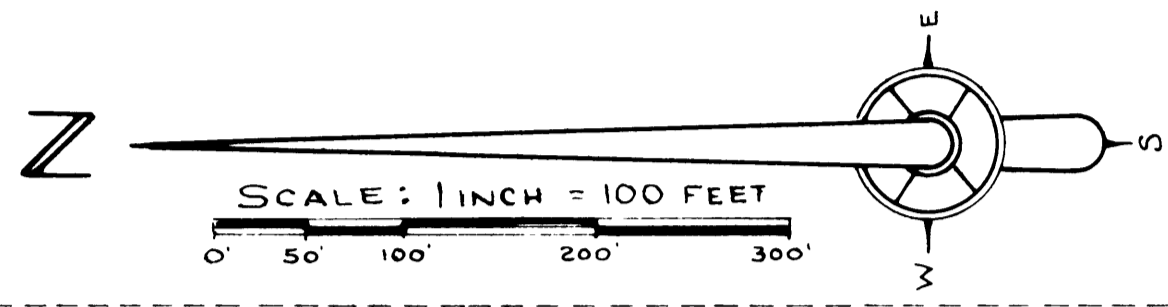
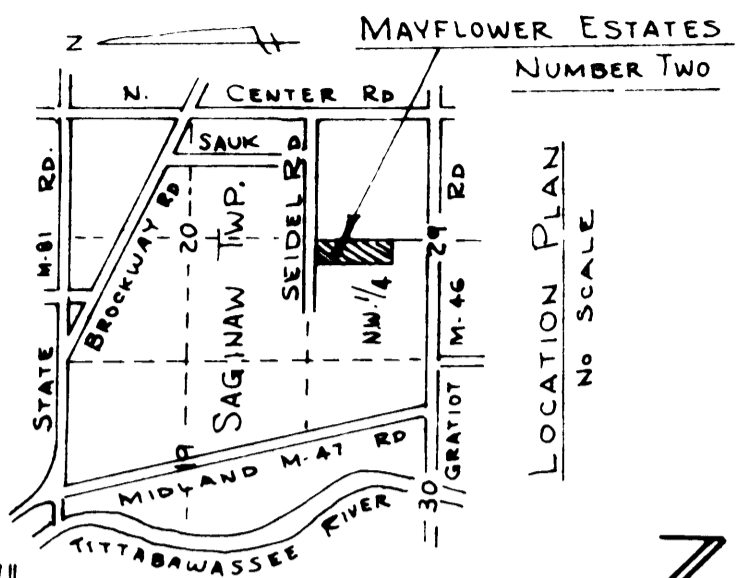

- 1 - ALL DIMENSIONS ARE GIVEN IN FEET
- 2 - CONCRETE MONUMENTS HAVE BEEN PLACED AT ALL POINTS MARKED "O"
- 3 - SET SOLID IRON BARS 1/2" IN DIA BY 18" IN LENGTH AT ALL LOT CORNERS
- 4 - BEARINGS ARE TRUE AS DETERMINED FROM A SOLAR OBSERVATION ON 12-13-67
- 5 - ALL RECORDED BEARINGS OF THE ADJOINING PLATS ARE SHOWN HEREON

