

SURVEYOR'S CERTIFICATE

I, ARTHUR H. LEACH, REGISTERED LAND SURVEYOR OF THE STATE OF MICHIGAN, HEREBY CERTIFY:

THAT THE SUBDIVISION PLAN KNOWN AS SAGINAW COUNTY CONDOMINIUM SUBDIVISION PLAN NO. 8 AS SHOWN ON THE ACCOMPANYING DRAWINGS, REPRESENTS A SURVEY ON THE GROUND MADE UNDER MY DIRECTION, THAT THERE ARE NO EXISTING ENCROACHMENTS UPON THE LANDS AND PROPERTY HEREIN DESCRIBED.

THAT THE REQUIRED MONUMENTS AND IRON MARKERS HAVE BEEN LOCATED IN THE GROUND AS REQUIRED BY RULES PROMULGATED UNDER SECTION 142 OF ACT NO. 59 OF THE PUBLIC ACTS OF 1978.

THAT THE ACCURACY OF THIS SURVEY IS WITHIN THE LIMITS REQUIRED BY THE RULES PROMULGATED UNDER SECTION 142 OF NO. 59 OF THE PUBLIC ACTS OF 1978.

THAT THE BEARINGS, AS SHOWN, ARE NOTED ON SURVEY PLAN AS REQUIRED BY THE RULES PROMULGATED UNDER SECTION 142 OF ACT NO. 59 OF THE PUBLIC ACTS OF 1978.

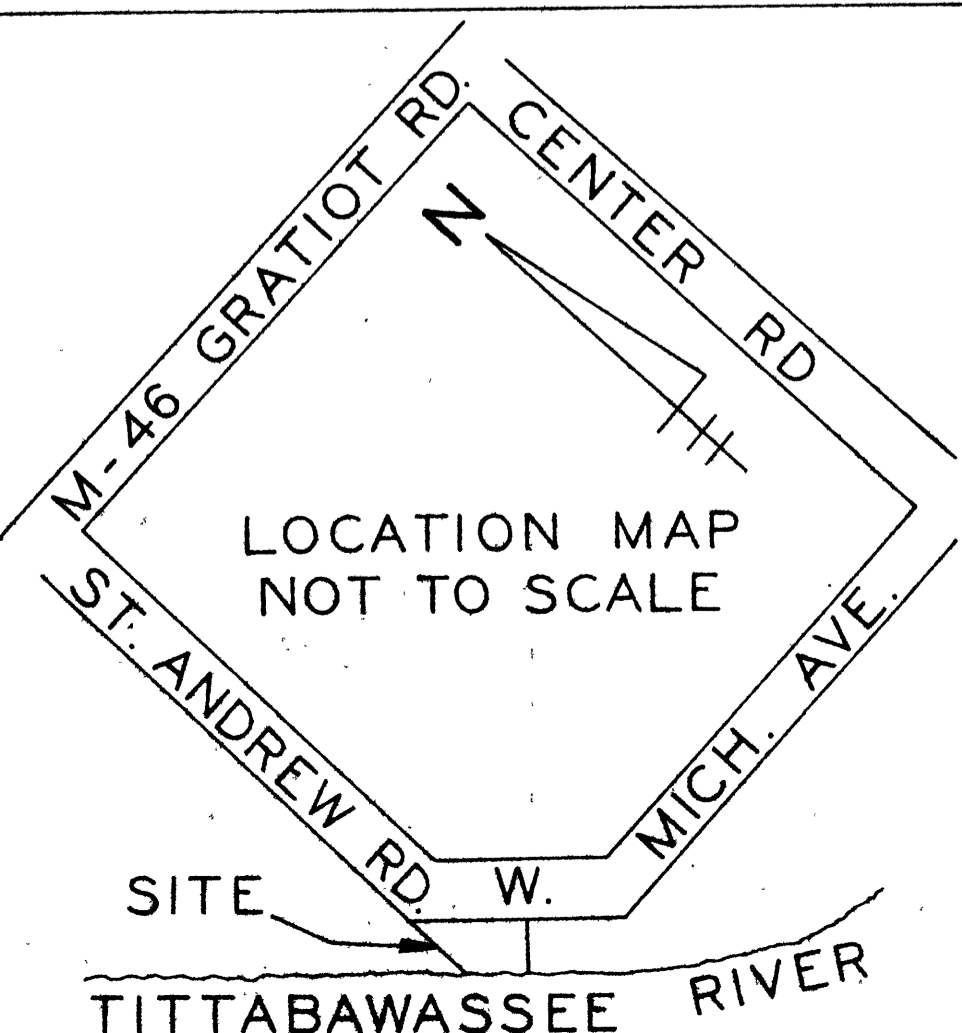

Arthur H. Leach 10-15-80

ARTHUR H. LEACH DATE REGISTERED LAND SURVEYOR REGISTRATION NO. 7236

LEACH ENGINEERING, INC. 3880 GROTTO ROAD, P.O. BOX NO. 251 BRIDGEPORT, MICHIGAN 48722 PHONE 517 - 777 - 1620

NOTE: CM=CONCRETE MONUMENT
 NOTE: ± =MORE OR LESS
 NOTE: BEARINGS AS SHOWN, ARE RECORDED IN RIVER FOREST SUBDIVISION, LIBER 9, PAGE 34, SAGINAW COUNTY RECORDS
 NOTE: ○ =COORDINATE POINT

SURVEY PLAN
RIVER FOREST CONDOMINIUM
 SCALE 1" = 40'

NOTE: ENTIRE PROPERTY IS WITHIN THE 100 YEAR FLOOD PLAIN, AS ESTABLISHED BY D.N.R. IS ELEV. 597.0 TO 597.3 U.S.G.S. DATA.



Arthur H. Leach

APPROVED
 APR 23 1981
 MICHIGAN DEPARTMENT OF COMMERCE CORPORATION & SECURITIES BUREAU

AS - BUILT
 OCTOBER 1, 1980
 ARTHUR H. LEACH REGISTERED LAND SURVEYOR REGISTRATION NO. 7236
 LEACH ENGINEERING, INC. 3880 GROTTO ROAD BRIDGEPORT, MICHIGAN 48722 PHONE 517 - 777 - 1620